

Hall of Knowledge Ground Floor

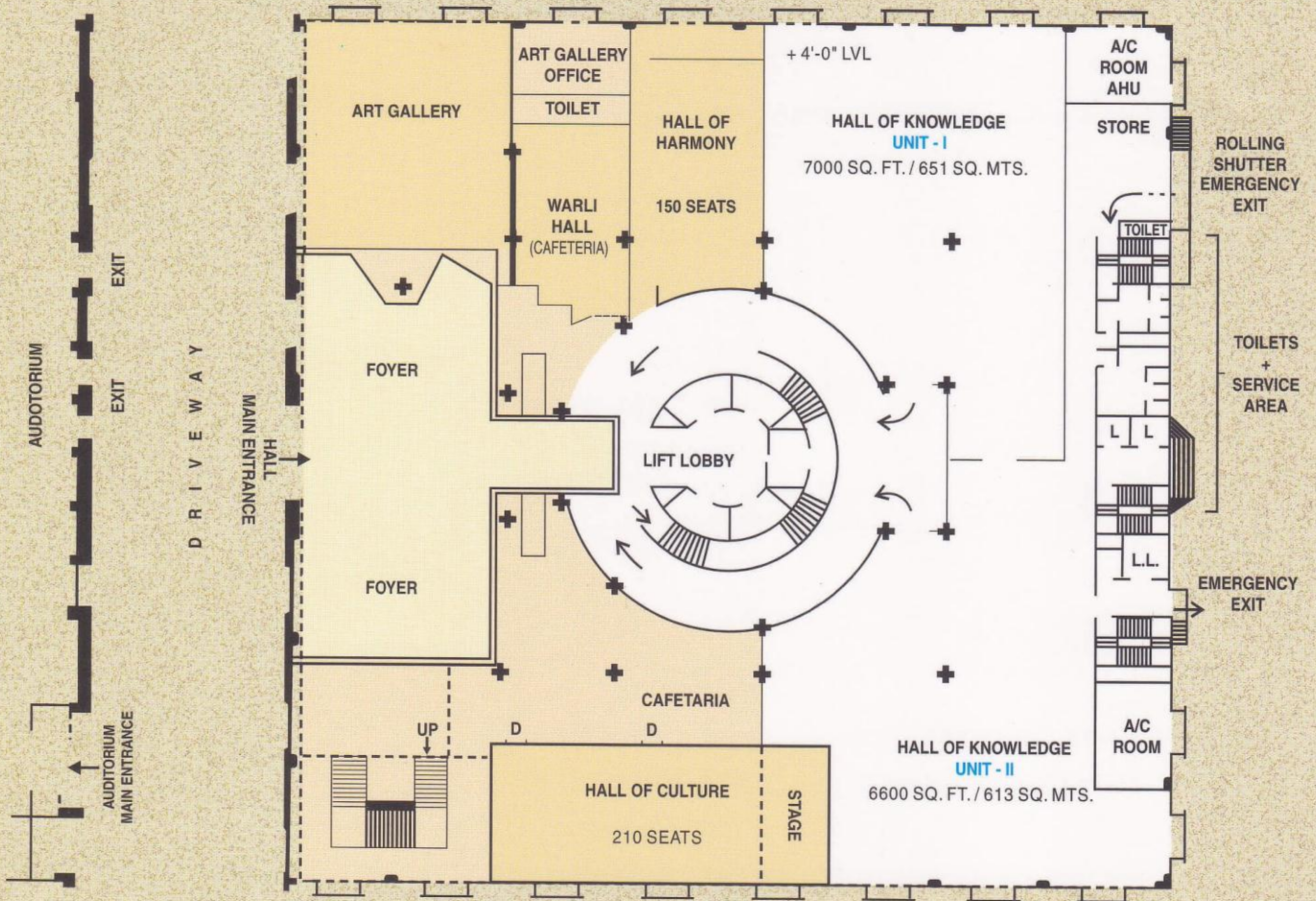

Salient Features of Hall of Knowledge

	Unit – I	Unit – II
AREA	7000.00 Sq. Ft.	6600.00 Sq. Ft.
(Gr. Floor)	(651.00 Sq. Mt.)	(613.00 Sq. Mt.)
CEILING	High Ceiling	High Ceiling
	Bottom of Tubes 18'-0''	Bottom of Tubes 18'-0''
	(18 Feet)	(18 Feet)
GEN. LIGHTING	Square 4'-0'' Tube Light Fitting.	
AIR CONDITION	Central Air Conditioned Hall.	
ELECTRICITY	Distribution Panels all along walls of Halls (Single & three phase power available with Prior intimation along with requirements.)	
TOILETS	Gents and Ladies common for all units & worker's toilets separate.	
DRINKING WATER	Cooler with ultraviolet purifier.	
PACKING & UNPACKING AREA	Behind Unit-I small area@750.00 Sq. Ft. (@ 70.00 Sq. Mt.)	
FLOOR LOAD	Light / Medium – Heavy Machines Possible with uniform distribution of load in consultation with engineer-in-charge.	

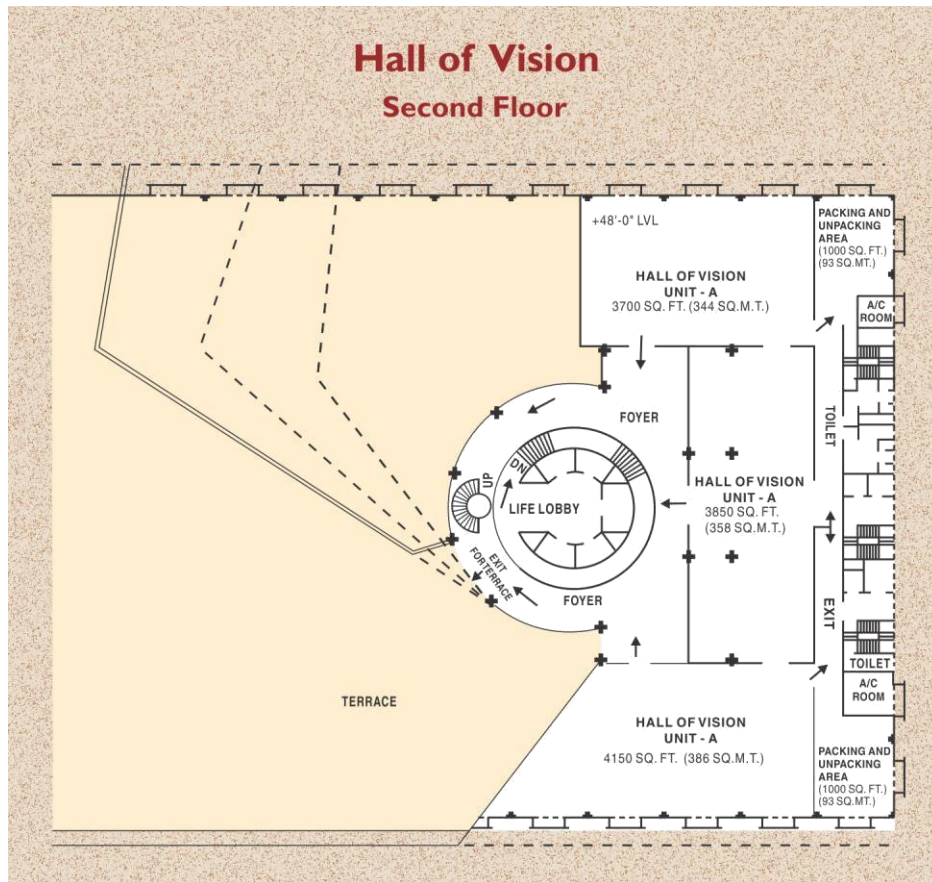

Salient Features of Hall of Vision

	Unit A	Unit B	Unit C
AREA	4150 Sq. Ft.	3850 Sq. Ft.	3700 Sq. Ft.
2 nd Floor (+48'-00')	(386 Sq. Mt.)	(358 Sq. Mt.)	(344 Sq. Mt.)
FALSE CEILING	14 Feet	14 Feet	14 Feet
GENERAL LIGHTING	Incandescent lamp (Recesses fixtures in the Ceiling)		
AIR CIRCULATION	Air Conditioned	Air Conditioned	Air Conditioned
ELECTRICITY	Distribution panels all along walls of halls (Single & three phase power available with prior intimation along with requirements.)		
TOILETS	Gents and Ladies common for all units & worker's toilets separate.		
DRINKING WATER	Water coolers in the back passage.		
PACKING- UNPACKING AREA (STORES)	1000 Sq. Ft. (100 Sq. Mt.) behind Unit A & Unit C.		
FLOOR LOAD	No Machinery allowed.		
FREIGHT LIFT FLOOR	8'-00'' Length x 5'-7'' Width x 6'-0'' Height (Capacity 2 Tonners).		
FREIGHT LIFT DOOR OPENING	3'-8'' Width x 6'-5'' Height		